

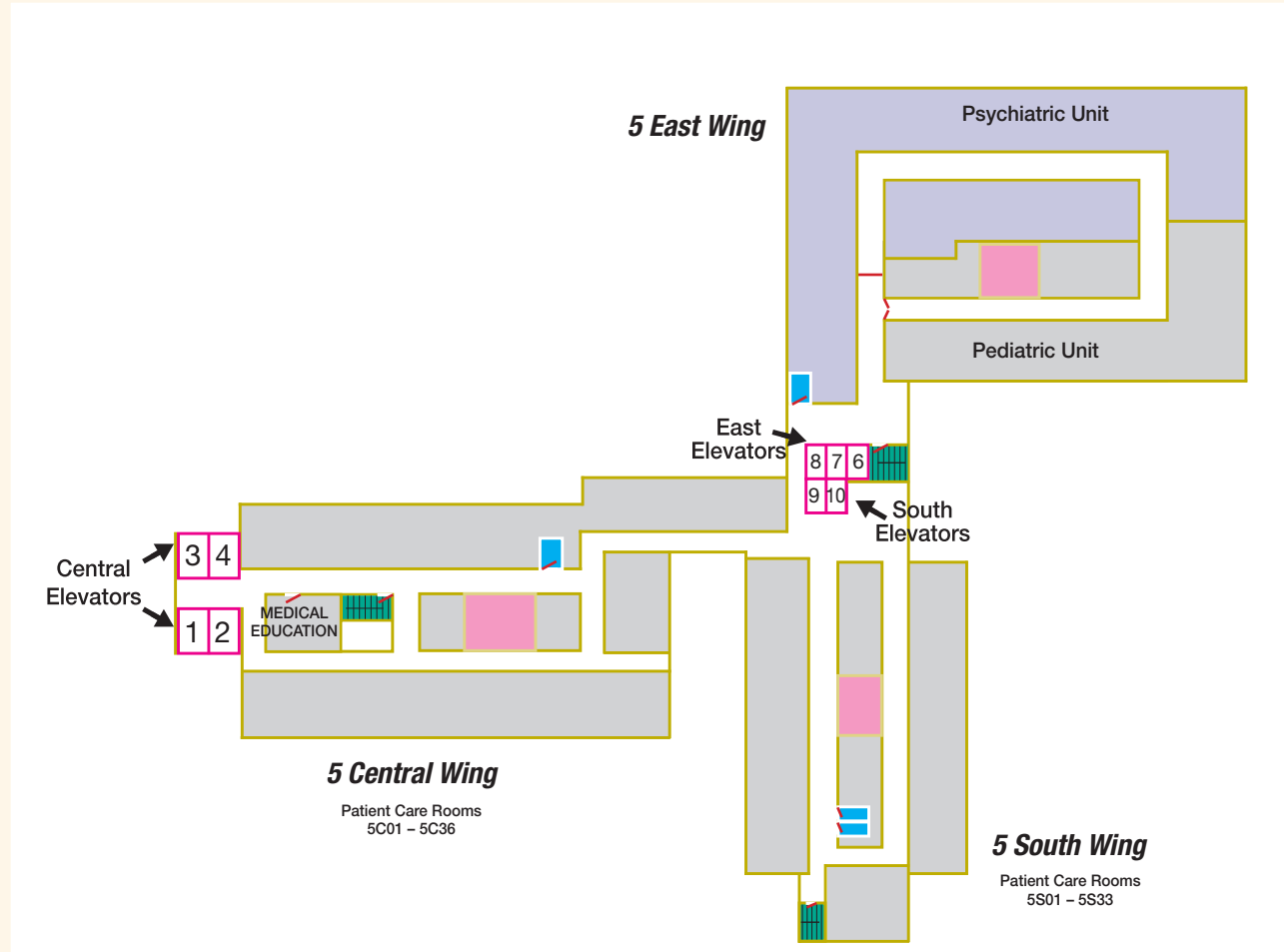

FIFTH FLOOR











Junipero Street



Bath Street

Pueblo Street

-  ENTRANCES
-  NURSE STATIONS
-  STAIRS
-  RESTROOMS
-  WAITING ROOMS
-  ELEVATORS
-  FOR CENTRAL WING PATIENT ROOMS:
USE CENTRAL ELEVATOR 1, 2, 3, or 4
-  FOR SOUTH & EAST WING PATIENT ROOMS:
USE SOUTH ELEVATOR 9 or 10
-  CRITICAL CARE PATIENT ROOMS:
USE ELEVATOR 12 or 14